

FORM NO 1.

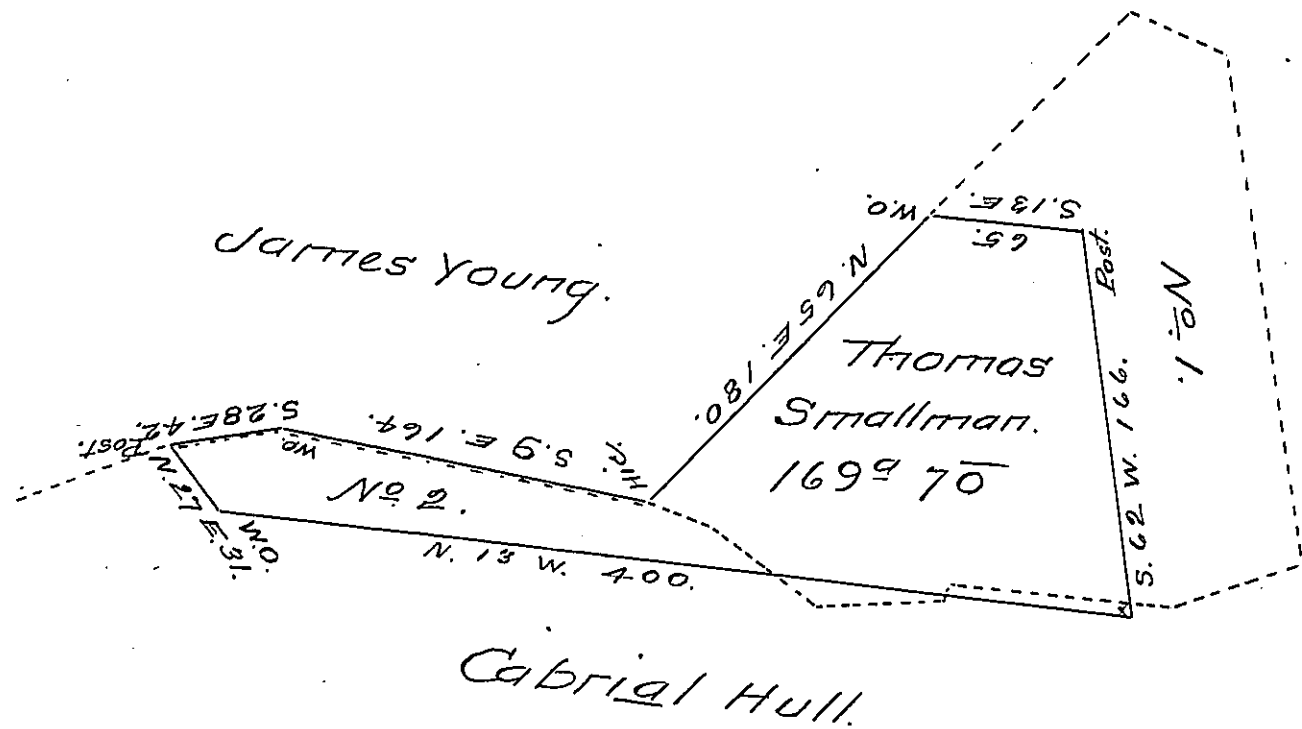

A Draft of A tract of land situate on the Shawnese Cabbin Creek near the mouth thereof In Napier Township Bedford County containing one hundred & sixty nine Acres & seventy perches with the usual allowance of six per cent for roads & ~~is~~ - Surveyed for Thomas Smallman the 31st. day of May 1799 In pursuance of A Warrant dated the 7th. day of July 1762. No. 1 represented by the broken lines - is a draft of A tract of land surveyed for Adam Hoops the 23rd day of October 1790 in pursuance of A Warrant dated the 9th. day of June 1762. This tract Interferes one hundred & twenty Eight Acres & thirty seven perches with the Thomas Smallman tract Adam Hoops ^{was} conveyed to Dr. John Anderson by the Treasurer of Bedford County for taxes. Dr. John Anderson now claims the land - No. 2. a survey made for Gabriel Hull on Warrant dated the _____ this interferes thirty Eight Acres and one Hundred & forty five perches. Gabriel Hull - is the present owner.

IN TESTIMONY that the above is a copy of the original remaining on file in the Department of Internal Affairs of Pennsylvania, made conformably to an Act of Assembly approved the 16th day of February, 1833, I have hereunto set my Hand and caused the Seal of said Department to be affixed at Harrisburg, this thirtieth day of October 1907.

Henry Howard
Secretary of Internal Affairs.